



City of Westminster

# Licensing Sub-Committee Report

Item No:	
Licensing Ref No:	<b>14/06493/LIPV</b>
Date:	<b>9<sup>th</sup> October 2014</b>
Classification:	<b>For General Release</b>
Title of Report:	<b>The Riding House Café 43 Great Titchfield Street London W1W 7PQ</b>
Report of:	<b>Operational Director of Premises Management</b>
Policy context:	<b>City of Westminster Statement of Licensing Policy</b>
Financial summary:	<b>None</b>
Report Author:	<b>Sumeet Anand-Patel, Environmental Health Case Officer (Licensing)</b>
Contact Details:	<b>Telephone: 020 7641 2737 E-mail: <a href="mailto:sanandpatel@westminster.gov.uk">sanandpatel@westminster.gov.uk</a></b>

## 1. APPLICATION DETAILS

<b>Application Type:</b>	Vary the premises licence under the Licensing Act 2003.		
<b>Applicant:</b>	Village London Central Limited	<b>Date Application Received:</b>	31 <sup>st</sup> July 2014 (validated again on 19.08.2014)
<b>Premises Name and Address:</b>	The Riding House Café 43 Great Titchfield Street London W1W 7PQ		
<b>Ward Name:</b>	West End	<b>Stress Area:</b>	No
<b>Description of Premises:</b>	This premises operates as a brasserie on the ground floor with a private dining room in the basement.		
<b>Summary of Variation</b>	The application for variation is to extend the terminal hours permitted for licensable activities and opening hours; 30 minutes Monday to Thursday, 1 hour Friday and Saturday, 30 minutes on Sunday (except for the sale of alcohol where 1 hours is being applied for).		
<i>Note: Where the committee is minded to grant the application it will be granted subject to the mandatory conditions and conditions consistent with the operating schedule modified to such extent as the authority considers appropriate for the promotion of the licensing objectives detailed in Appendix D to this report.</i>			
<b>Proposed Licensable Activities, Proposed Hours:</b>			<b>References / Notes</b>
<b>1.</b>	<b>To vary hours permitted for the showing of films:</b>		
	<p><b>Current Licensed Hours:</b> Monday to Thursday 09:30 to 23:30 Friday to Saturday 09:30 to 00:00 Sunday: 12:00 to 23:00 Sunday BBH: 12:00 to 00:00</p>	<p><b>Proposed Licensed Hours:</b> Monday to Thursday 09:30 to <b>00:00</b> Friday to Saturday 09:30 to <b>01:00</b> Sunday: 12:00 to <b>23:30</b> Sunday BBH: No variation applied for</p>	
	<b>Relevant representations and policies applicable:</b>		
<b>1A</b>	A local resident has submitted a representation in support of the application stating that the premises operate as a less disruptive venue compared to neighbouring premises. Please refer to <b>Appendix B1</b> .		<b>Local resident representation (in support)</b>
<b>1B</b>	Environmental Health Consultation Team have submitted an adverse representation to this proposal stating that the proposals will lead to an increase in public nuisance in the West End Stress Area and are against policy. Please refer to <b>Appendix B2</b> for further information. Environmental Health have proposed conditions which are attached at <b>Appendix D</b> .		<b>Environmental Health Service Representation and conditions</b>
<b>1C</b>	2 local residents have submitted adverse representations against the application on the grounds of public nuisance. Please refer to <b>Appendices B3 and B4</b> for further information.		<b>2 local resident representations</b>
<b>1D</b>	The following policies within the City Of Westminster Statement of Licensing Policy apply:  Prevention of crime and disorder (CD1) Public Safety (PS1) Prevention of public nuisance (PN1) Protection children from harm (CH1) Hours (HRS1) Public Houses and Bars outside the Stress Areas (PB1) Restaurants outside the Stress Areas (RNT1)		<b>Policies applicable</b>
<b>1E</b>	<b>Policy HRS1 applies:</b> (i) Applications for hours within the core hours set out in this policy will		

	<p>generally be granted, subject to not being contrary to other policies in the Statement of Licensing Policy.</p> <p>(ii) Applications for hours outside the core hours in this policy will be considered on their merits, subject to other relevant policies and with particular regard to criteria set out in the policy.</p> <p><b>1F Policy PB1 applies:</b> Applications will only be granted if it can be demonstrated that the proposal meets the relevant criteria in Policies CD1, PS1, PN1 and CH1.</p> <p><b>1G Policy RNT1 applies:</b> Applications will generally be granted and reviews determined, subject to the relevant criteria in Policies CD1, PS1, PN1 and CH1.</p> <p><b>1H</b> The Licensing Sub-committee may refuse, grant in full or grant in part this proposal, having taken into account the representations received and Westminster's Statement of Licensing Policy. The decision taken should promote the licensing objectives of:</p> <ul style="list-style-type: none"> <li>• prevention of public nuisance,</li> <li>• prevention of crime &amp; disorder,</li> <li>• public safety and</li> <li>• protection of children from harm.</li> </ul>	<b>Summary</b>		
<b>2.</b>	<p><b>To vary the hours permitted for late night refreshment: Indoors</b></p> <table border="0" style="width: 100%;"> <tr> <td style="width: 50%; vertical-align: top;"> <p><b>Current licensed hours:</b> Monday to Thursday 23:00 to 23:30 Friday to Saturday 23:00 to 00:00 Sunday: Not licensed Sunday BBH: 23:00 to 00:00</p> </td> <td style="width: 50%; vertical-align: top;"> <p><b>Proposed licensed hours:</b> Monday to Thursday 23:00 to <b>00:00</b> Friday to Saturday 23:00 to <b>01:00</b> Sunday: <b>23:00 to 23:30</b> Sunday BBH: No variation applied for</p> </td> </tr> </table> <p><b>Relevant representations and policies applicable:</b></p> <p><b>2A</b> Please refer to 1B to 1G above.</p> <p><b>2B</b> The Licensing Sub-committee may refuse, grant in full or grant in part this proposal, having taken into account the representations received and Westminster's Statement of Licensing Policy. The decision taken should promote the licensing objectives of:</p> <ul style="list-style-type: none"> <li>• prevention of public nuisance,</li> <li>• prevention of crime &amp; disorder,</li> <li>• public safety and</li> <li>• protection of children from harm.</li> </ul>	<p><b>Current licensed hours:</b> Monday to Thursday 23:00 to 23:30 Friday to Saturday 23:00 to 00:00 Sunday: Not licensed Sunday BBH: 23:00 to 00:00</p>	<p><b>Proposed licensed hours:</b> Monday to Thursday 23:00 to <b>00:00</b> Friday to Saturday 23:00 to <b>01:00</b> Sunday: <b>23:00 to 23:30</b> Sunday BBH: No variation applied for</p>	<p><b>Opposed by EH and 2 local residents</b></p> <p><b>Summary</b></p>
<p><b>Current licensed hours:</b> Monday to Thursday 23:00 to 23:30 Friday to Saturday 23:00 to 00:00 Sunday: Not licensed Sunday BBH: 23:00 to 00:00</p>	<p><b>Proposed licensed hours:</b> Monday to Thursday 23:00 to <b>00:00</b> Friday to Saturday 23:00 to <b>01:00</b> Sunday: <b>23:00 to 23:30</b> Sunday BBH: No variation applied for</p>			
<b>3.</b>	<p><b>To vary the hours permitted for the sale of alcohol: On and Off</b></p> <table border="0" style="width: 100%;"> <tr> <td style="width: 50%; vertical-align: top;"> <p><b>Current Licensed Hours:</b> Monday to Thursday 10:00 to 23:30 Friday to Saturday 10:00 to 00:00 Sunday: 12:00 to 22:30 Sunday BBH: 12:00 to 00:00</p> </td> <td style="width: 50%; vertical-align: top;"> <p><b>Proposed Licensed Hours:</b> Monday to Thursday 10:00 to <b>00:00</b> Friday to Saturday 10:00 to <b>01:00</b> Sunday: 12:00 to <b>23:30</b> Sunday BBH: No variation applied for</p> </td> </tr> </table> <p><b>Relevant representations and policies applicable:</b></p> <p><b>3A</b> Please refer to 1B to 1G above.</p> <p><b>3B</b> The Licensing Sub-committee may refuse, grant in full or grant in part this proposal, having taken into account the representations received and Westminster's Statement of Licensing Policy. The decision taken should promote the licensing objectives of:</p>	<p><b>Current Licensed Hours:</b> Monday to Thursday 10:00 to 23:30 Friday to Saturday 10:00 to 00:00 Sunday: 12:00 to 22:30 Sunday BBH: 12:00 to 00:00</p>	<p><b>Proposed Licensed Hours:</b> Monday to Thursday 10:00 to <b>00:00</b> Friday to Saturday 10:00 to <b>01:00</b> Sunday: 12:00 to <b>23:30</b> Sunday BBH: No variation applied for</p>	<p><b>Opposed by EH and 2 local residents</b></p>
<p><b>Current Licensed Hours:</b> Monday to Thursday 10:00 to 23:30 Friday to Saturday 10:00 to 00:00 Sunday: 12:00 to 22:30 Sunday BBH: 12:00 to 00:00</p>	<p><b>Proposed Licensed Hours:</b> Monday to Thursday 10:00 to <b>00:00</b> Friday to Saturday 10:00 to <b>01:00</b> Sunday: 12:00 to <b>23:30</b> Sunday BBH: No variation applied for</p>			

- prevention of public nuisance,
- prevention of crime & disorder,
- public safety and
- protection of children from harm.

**4. To vary the opening hours:**

**Current Opening Hours:**

Monday to Thursday 09:30 to 23:30  
 Friday to Saturday 09:30 to 00:00  
 Sunday: 12:00 to 23:30  
 Sunday BBH: 12:00 to 00:00

**Proposed Opening Hours:**

Monday to Thursday 09:30 to **00:00**  
 Friday to Saturday 09:30 to **01:00**  
 Sunday: No variation applied for  
 Sunday BBH: No variation applied for

*(Note: Opening hours are not a licensable activity under the Licensing Act 2003, however they can still be taken into consideration when assessing the application's effect on the licensing objectives.)*

**Relevant representations and policies applicable:**

**4A** Please refer to 1B to 1G above.

**4B** The Licensing Sub-committee may refuse, grant in full or grant in part this proposal, having taken into account the representations received and Westminster's Statement of Licensing Policy. The decision taken should promote the licensing objectives of:

- prevention of public nuisance,
- prevention of crime & disorder,
- public safety and
- protection of children from harm.

**Opposed by EH and 2 local residents**

Existing Premises Licence (13/10224/LIPDPS)	Proposed Licensable Activities
<p><b>Regulated Entertainment: Indoors</b></p> <p><b>Exhibition of a Film</b>            Monday to Thursday 09:30 to 23:30            Friday to Saturday 09:30 to 00:00            Sunday: 12:00 to 23:00            Sunday BBH: 12:00 to 00:00</p> <p><b>Recorded Music:</b>            Unrestricted</p> <p><b>Private entertainment consisting of dancing, music or other entertainment of a like kind for consideration and with a view to profit</b>            Unrestricted</p>	<p><b>Regulated Entertainment: Indoors</b></p> <p><b>Exhibition of a Film</b>            Monday to Thursday 09:30 to <b>00:00</b>            Friday to Saturday 09:30 to <b>01:00</b>            Sunday: 12:00 to <b>23:30</b>            Sunday BBH: No variation applied for</p> <p><b>Recorded Music:</b>            No variation applied for</p> <p><b>Private entertainment consisting of dancing, music or other entertainment of a like kind for consideration and with a view to profit</b>            No variation applied for</p>
<p><b>Late Night Refreshment: Indoors</b></p> <p>Monday to Thursday 23:00 to 23:30            Friday to Saturday 23:00 to 00:00            Sunday: Not licensed            Sunday BBH: 23:00 to 00:00</p>	<p><b>Late Night Refreshment: Indoors</b></p> <p>Monday to Thursday 23:00 to <b>00:00</b>            Friday to Saturday 23:00 to <b>01:00</b>            Sunday: <b>23:00 to 23:30</b>            Sunday BBH: No variation applied for</p>
<p><b>Sale by Retail of Alcohol: On and Off</b></p> <p>Monday to Thursday 10:00 to 23:30            Friday to Saturday 10:00 to 00:00            Sunday: 12:00 to 22:30</p>	<p><b>Sale by Retail of Alcohol: On and Off</b></p> <p>Monday to Thursday 10:00 to <b>00:00</b>            Friday to Saturday 10:00 to <b>01:00</b>            Sunday: 12:00 to <b>23:30</b></p>

<b>Sunday BBH: 12:00 to 00:00</b>		<b>Sunday BBH: No variation applied for</b>	
<b>Capacity:</b>  No capacity conditioned on licence		<b>Capacity:</b>  No capacity proposed	
<b>Opening Hours:</b>  Monday to Thursday 09:30 to 23:30 Friday to Saturday 09:30 to 00:00 Sunday: 12:00 to 23:30 Sunday BBH: 12:00 to 00:00		<b>Opening Hours:</b>  Monday to Thursday 09:30 to <b>00:00</b> Friday to Saturday 09:30 to <b>01:00</b> Sunday: No variation applied for Sunday BBH: No variation applied for	
<b>Current Licensing Position</b>	The premises are currently licensed, under reference <b>13/10224/LIPDPS</b> please refer to the licence at <b>Appendix A2</b> .  Full licence history is provided at <b>Appendix C</b> .		
<b>Current Planning Position</b>	Planning comments requested.		
<b>Residential Density:</b>	191 of the 376 units within a 75m radius of the premises are residential, proposed residential and residential under construction (51%), refer to <b>Appendix E</b>		
<b>List of Appendices:</b>	A1 – Application Form A2 – Current Licence B1 – Mr Bart representation in support B2 – Environmental Health representation and conditions B3 to B4 – Local resident representations C – Premises Licence History D – Conditions E – Residential Map and list of premises in the vicinity F – Photo of premises		
<b>Relevant Representations:</b>	Environmental Health 3 x local resident (one in support)		

## 2. APPLICANT SUBMISSIONS AND EVIDENCE

2.1 The evidence submitted by the applicant in support of the Licensing Objectives is provided in **Appendix A1**.

## 3. LICENSING ACT 2003 APPLICATIONS AND APPEAL HISTORY

3.1 Any chronology relating to appeals is set out in Appendix C.

### Background Documents – Local Government (Access to Information) Act 1972

- Licensing Act 2003
- City of Westminster Statement of Licensing Policy (7<sup>th</sup> January 2011)
- Amended Guidance issued under section 182 of the Licensing Act 2003 (June 2013)

# APPENDIX A1

Thomas & Thomas <sup>2</sup>

PREMISES MANAGEMENT  
LICENSING SERVICE

31 JUL 2014

CITY OF WESTMINSTER

## Application to vary a premises licence under the Licensing Act 2003

### PLEASE READ THE FOLLOWING INSTRUCTIONS FIRST

Before completing this form please read the guidance notes at the end of the form. If you are completing this form by hand please write legibly in block capitals. In all cases ensure that your answers are inside the boxes and written in black ink. Use additional sheets if necessary.

You may wish to keep a copy of the completed form for your records.

I/We Village London Central Limited

*(Insert name(s) of applicant)*

being the premises licence holder, apply to vary a premises licence under section 34 of the Licensing Act 2003 for the premises described in Part 1 below

Premises licence number

13/10224/LIPDPS

### Part 1 – Premises Details

Postal address of premises or, if none, ordnance survey map reference or description

The Riding House Café  
43 Great Titchfield Street

Post town

London

Postcode

W1W 7PQ

Telephone number at premises (if any)

Non-domestic rateable value of premises

£157000

### Part 2 – Applicant details

Daytime contact  
telephone number

E-mail address (optional)

Current postal address if  
different from premises address

Post town

Postcode

**Part 3 - Variation**

Please tick as appropriate

Do you want the proposed variation to have effect as soon as possible?  Yes  No

If not, from what date do you want the variation to take effect?

DD		MM		YYYY			
┆	┆	┆	┆	┆	┆	┆	┆

Do you want the proposed variation to have effect in relation to the introduction of the late night levy?  
(Please see Guidance Note 1)  Yes  No

**Please describe briefly the nature of the proposed variation (Please see guidance note 2)**  
Following the recent grant of planning permission 14/02209/FULL the application is to extend the opening hours of the premises and the permitted hours for the showing of films, provision of late night refreshment and sale by retail of alcohol as follows:

- Until 0000 Monday to Thursday (30 minute extension)
- Until 0100 Friday to Saturday (60 minute extension)
- Until 2330 Sunday (30 minute extension)

If your proposed variation would mean that 5,000 or more people are expected to attend the premises at any one time, please state the number expected to attend:

**Part 4 Operating Schedule**

Please complete those parts of the Operating Schedule below which would be subject to change if this application to vary is successful.

**Provision of regulated entertainment**

**Please tick all that apply**

- a) plays (if ticking yes, fill in box A)
- b) films (if ticking yes, fill in box B)
- c) indoor sporting events (if ticking yes, fill in box C)
- d) boxing or wrestling entertainment (if ticking yes, fill in box D)
- e) live music (if ticking yes, fill in box E)
- f) recorded music (if ticking yes, fill in box F)
- g) performances of dance (if ticking yes, fill in box G)
- h) anything of a similar description to that falling within (e), (f) or (g)  
(if ticking yes, fill in box H)

**Provision of late night refreshment** (if ticking yes, fill in box I)

**Sale by retail of alcohol** (if ticking yes, fill in box J)

**In all cases complete boxes K, L and M**



A

Plays Standard days and timings (please read guidance note 7)			Will the performance of a play take place indoors or outdoors or both – please tick (please read guidance note 3)	Indoors	<input type="checkbox"/>
				Outdoors	<input type="checkbox"/>
				Both	<input type="checkbox"/>
Day	Start	Finish	Please give further details here (please read guidance note 4)		
Mon					
			State any seasonal variations for performing plays (please read guidance note 5)		
Tue					
			Non standard timings. Where you intend to use the premises for the performance of plays at different times to those listed in the column on the left, please list (please read guidance note 6)		
Wed					
Thur					
Fri					
Sat					
Sun					

**B**

Films Standard days and timings (please read guidance note 7)			Will the exhibition of films take place indoors or outdoors or both – please tick (please read guidance note 3)	Indoors	<input checked="" type="checkbox"/>
				Outdoors	<input type="checkbox"/>
				Both	<input type="checkbox"/>
Day	Start	Finish	Please give further details here (please read guidance note 4)		
Mon	0930	0000			
			State any seasonal variations for the exhibition of films (please read guidance note 5)		
Tue	0930	0000			
			Non standard timings. Where you intend to use the premises for the exhibition of films at different times to those listed in the column on the left, please list (please read guidance note 6) Sundays before Bank Holidays 1200 to 0000 (as existing)		
Wed	0930	0000			
Thur	0930	0000			
Fri	0930	0100			
Sat	0930	0100			
Sun	1200	2330			

C

Indoor sporting events Standard days and timings (please read guidance note 7)			<u>Please give further details</u> (please read guidance note 4)
Day	Start	Finish	
Mon			
Tue			<u>State any seasonal variations for indoor sporting events</u> (please read guidance note 5)
Wed			
Thur			<u>Non standard timings. Where you intend to use the premises for indoor sporting events at different times to those listed in the column on the left, please list</u> (please read guidance note 6)
Fri			
Sat			
Sun			

D

<b>Boxing or wrestling entertainments</b> <b>Standard days and timings</b> (please read guidance note 7)			<u>Will the boxing or wrestling entertainment take place indoors or outdoors or both – please tick</u> (please read guidance note 3)	Indoors	<input type="checkbox"/>
				Outdoors	<input type="checkbox"/>
				Both	<input type="checkbox"/>
<b>Day</b>	<b>Start</b>	<b>Finish</b>	<u>Please give further details here</u> (please read guidance note 4)		
Mon					
Tue			<u>State any seasonal variations for boxing or wrestling entertainment</u> (please read guidance note 5)		
Wed					
Thur			<u>Non standard timings. Where you intend to use the premises for boxing or wrestling entertainment at different times to those listed in the column on the left, please list</u> (please read guidance note 6)		
Fri					
Sat					
Sun					

E

Live music Standard days and timings (please read guidance note 7)			<u>Will the performance of live music take place indoors or outdoors or both – please tick (please read guidance note 3)</u>	Indoors	<input type="checkbox"/>
				Outdoors	<input type="checkbox"/>
				Both	<input type="checkbox"/>
Day	Start	Finish	<u>Please give further details here (please read guidance note 4)</u>  <u>State any seasonal variations for the performance of live music (please read guidance note 5)</u>  <u>Non standard timings. Where you intend to use the premises for the performance of live music at different times to those listed in the column on the left, please list (please read guidance note 6)</u>		
Mon					
Tue					
Wed					
Thur					
Fri					
Sat					
Sun					

F

Recorded music Standard days and timings (please read guidance note 7)			<u>Will the playing of recorded music take place indoors or outdoors or both – please tick (please read guidance note 3)</u>	Indoors	<input type="checkbox"/>
				Outdoors	<input type="checkbox"/>
				Both	<input type="checkbox"/>
Day	Start	Finish	<u>Please give further details here (please read guidance note 4)</u> UNRESTRICTED - NO AMENDMENT SOUGHT		
Mon					
Tue					
			<u>State any seasonal variations for the playing of recorded music (please read guidance note 5)</u>		
Wed					
Thur					
			<u>Non standard timings. Where you intend to use the premises for the playing of recorded music at different times to those listed in the column on the left, please list (please read guidance note 6)</u>		
Fri					
Sat					
Sun					

G

Performances of dance Standard days and timings (please read guidance note 7)			Will the performance of dance take place indoors or outdoors or both – please tick (please read guidance note 3)	Indoors	<input type="checkbox"/>
				Outdoors	<input type="checkbox"/>
				Both	<input type="checkbox"/>
Day	Start	Finish	Please give further details here (please read guidance note 4)		
Mon					
Tue					
Wed			State any seasonal variations for the performance of dance (please read guidance note 5)		
Thur					
Fri			Non standard timings. Where you intend to use the premises for the performance of dance at different times to those listed in the column on the left, please list (please read guidance note 6)		
Sat					
Sun					

H

<b>Anything of a similar description to that falling within (e), (f) or (g)</b> Standard days and timings (please read guidance note 7)			Please give a description of the type of entertainment you will be providing		
Day	Start	Finish	<b>Will this entertainment take place indoors or outdoors or both – please tick</b> (please read guidance note 3)	Indoors	<input type="checkbox"/>
Mon				Outdoors	<input type="checkbox"/>
				Both	<input type="checkbox"/>
Tue			<b>Please give further details here</b> (please read guidance note 4)		
Wed					
Thur			<b>State any seasonal variations for entertainment of a similar description to that falling within (e), (f) or (g)</b> (please read guidance note 5)		
Fri					
Sat			<b>Non standard timings. Where you intend to use the premises for the entertainment of a similar description to that falling within (e), (f) or (g) at different times to those listed in the column on the left, please list</b> (please read guidance note 6)		
Sun					



1

<b>Late night refreshment</b> Standard days and timings (please read guidance note 7)			<b>Will the provision of late night refreshment take place indoors or outdoors or both – please tick</b> (please read guidance note 3)	Indoors	<input checked="" type="checkbox"/>
				Outdoors	<input type="checkbox"/>
				Both	<input type="checkbox"/>
<b>Day</b>	<b>Start</b>	<b>Finish</b>	<b>Please give further details here</b> (please read guidance note 4)		
Mon	2300	0000			
Tue	2300	0000	<b>State any seasonal variations for the provision of late night refreshment</b> (please read guidance note 5)		
Wed	2300	0000			
Thur	2300	0000	<b>Non standard timings. Where you intend to use the premises for the provision of late night refreshment at different times, to those listed in the column on the left, please list</b> (please read guidance note 6) Sundays before Bank Holidays 1200 to 0000 (as existing)		
Fri	2300	0100			
Sat	2300	0100			
Sun	2300	2330			

J

<b>Supply of alcohol</b> Standard days and timings (please read guidance note 7)			<b>Will the supply of alcohol be for consumption – please tick (please read guidance note 6)</b>	On the premises	<input type="checkbox"/>
				Off the premises	<input type="checkbox"/>
				Both	<input checked="" type="checkbox"/>
<b>Day</b>	<b>Start</b>	<b>Finish</b>	<b>State any seasonal variations for the supply of alcohol (please read guidance note 5)</b>		
Mon	1000	0000			
Tue	1000	0000			
Wed	1000	0000			
Thur	1000	0000			
Fri	1000	0100			
Sat	1000	0100			
Sun	1200	2330			

K

<p><b>Please highlight any adult entertainment or services, activities, other entertainment or matters ancillary to the use of the premises that may give rise to concern in respect of children (please read guidance note 9).</b></p> <p>None</p>
---

L

<b>Hours premises are open to the public</b> <b>Standard days and timings</b> (please read guidance note 7)			<b>State any seasonal variations</b> (please read guidance note 5)
Day	Start	Finish	
Mon	0930	0000	
Tue	0930	0000	
Wed	0930	0000	
Thur	0930	0000	
Fri	0930	0100	
Sat	0930	0100	
Sun	1200	2330	

**Non standard timings. Where you intend the premises to be open to the public at different times from those listed in the column on the left, please list** (please read guidance note 6)  
 Sundays before Bank Holidays 1200 to 0000 (as existing)

Please identify those conditions currently imposed on the licence which you believe could be removed as a consequence of the proposed variation you are seeking.

None

Please tick as appropriate

• I have enclosed the premises licence

• I have enclosed the relevant part of the premises licence

If you have not ticked one of these boxes, please fill in reasons for not including the licence or part of it below

Reasons why I have not enclosed the premises licence or relevant part of premises licence.

## **M**

Describe any additional steps you intend to take to promote the four licensing objectives as a result of the proposed variation:

### **a) General – all four licensing objectives (b, c, d and e) (please read guidance note 10)**

The conditions currently attached to the premises licence will continue to have effect should the variation be granted, including condition 25 which states that "After 23:00 alcohol can only be served in the ground floor dining room or in the basement private dining room as ancillary to a substantial bar snack or full table meal or to patrons waiting to dine or having dined."

In addition the following condition that is consistent with the recently granted planning permission is proposed:

"No deliveries shall be taken at or dispatched from the site outside the hours of 0900 and 1800 Mondays to Saturdays and not at any time on Sundays or Bank or Public Holidays."

### **b) The prevention of crime and disorder**

Please refer to box a) above

### **c) Public safety**

Please refer to box a) above

### **d) The prevention of public nuisance**

Please refer to box a) above

**e) The protection of children from harm**

Please refer to box a) above

**Checklist:**

**Please tick to indicate agreement**

- I have made or enclosed payment of the fee.
- I have sent copies of this application and the plan to responsible authorities and others where applicable.
- I understand that I must now advertise my application.
- I have enclosed the premises licence or relevant part of it or explanation.
- I understand that if I do not comply with the above requirements my application will be rejected.

**IT IS AN OFFENCE, LIABLE ON SUMMARY CONVICTION TO A FINE NOT EXCEEDING LEVEL 5 ON THE STANDARD SCALE, UNDER SECTION 158 OF THE LICENSING ACT 2003, TO MAKE A FALSE STATEMENT IN OR IN CONNECTION WITH THIS APPLICATION.**

**Part 5 – Signatures (please read guidance note 11)**

**Signature of applicant (the current premises licence holder) or applicant's solicitor or other duly authorised agent (please read guidance note 12). If signing on behalf of the applicant, please state in what capacity.**

Signature	<i>Thomas &amp; Thomas</i>
Date	31/07/2014
Capacity	Thomas & Thomas Partners LLP, Solicitors on behalf fo the applicant

**Where the premises licence is jointly held, signature of 2nd applicant (the current premises licence holder) or 2nd applicant's solicitor or other authorised agent (please read guidance note 13). If signing on behalf of the applicant, please state in what capacity.**

Signature	
Date	
Capacity	

**Contact name (where not previously given) and address for correspondence associated with this application (please read guidance note 14)**

AC/VIL.1.2

Thomas & Thomas Partners LLP

38a Monmouth Street

<b>Post town</b>	London	<b>Post code</b>	WC2H 9EP
------------------	--------	------------------	----------

<b>Telephone number (if any)</b>	020 7042 0418
----------------------------------	---------------

**If you would prefer us to correspond with you by e-mail, your e-mail address (optional)**

acatlin@tandtp.com

#### Notes for Guidance

**This application cannot be used to vary the licence so as to extend the period for which the licence has effect or to vary substantially the premises to which it relates. If you wish to make that type of change to the premises licence, you should make a new premises licence application under section 17 of the Licensing Act 2003.**

1. You do not have to pay a fee if the only purpose of the variation for which you are applying is to avoid becoming liable to the late night levy.
2. Describe the premises. For example the type of premises, its general situation and layout and any other information which could be relevant to the licensing objectives. Where your application includes off-supplies of alcohol and you intend to provide a place for consumption of these off-supplies, you must include a description of where the place will be and its proximity to the premises.
3. Where taking place in a building or other structure please tick as appropriate (indoors may include a tent).
4. For example state type of activity to be authorised, if not already stated, and give relevant further details, for example (but not exclusively) whether or not music will be amplified or unamplified.
5. For example (but not exclusively), where the activity will occur on additional days during the summer months.
6. For example (but not exclusively), where you wish the activity to go on longer on a particular day e.g. Christmas Eve.
7. Please give timings in 24 hour clock (e.g. 16:00) and only give details for the days of the week when you intend the premises to be used for the activity.
8. If you wish people to be able to consume alcohol on the premises, please tick 'on the premises'. If you wish people to be able to purchase alcohol to consume away from the premises, please tick 'off the premises'. If you wish people to be able to do both, please tick 'both'.
9. Please give information about anything intended to occur at the premises or ancillary to the use of the premises which may give rise to concern in respect of children regardless of whether you intend children to have access to the premises, for example (but not exclusively) nudity or semi-nudity, films for restricted age groups or the presence of gaming machines.
10. Please list here steps you will take to promote all four licensing objectives together.
11. The application form must be signed.
12. An applicant's agent (for example solicitor) may sign the form on their behalf provided that they have actual authority to do so.
13. Where there is more than one applicant, each of the applicants or their respective agents must sign the application form.
14. This is the address which we shall use to correspond with you about this application.

# APPENDIX A2



Schedule 12  
Part A

WARD: West End  
UPRN: 100023622103

## City of Westminster

64 Victoria Street, London, SW1E 6QP

Premises licence

Regulation 33, 34

Premises licence number:

13/10224/LIPDPS

Original Reference:

05/04445/LIPCV

### Part 1 – Premises details

#### Postal address of premises:

The Riding House Café  
43 Great Titchfield Street  
London  
W1W 7PQ

Telephone Number: Not Supplied

#### Where the licence is time limited, the dates:

Not applicable

#### Licensable activities authorised by the licence:

Exhibition of a Film  
Playing of Recorded Music  
Late Night Refreshment  
Private Entertainment consisting of dancing, music or other entertainment of a like kind for consideration and with a view to profit  
Sale by Retail of Alcohol

#### The times the licence authorises the carrying out of licensable activities:

##### Exhibition of a Film

Monday to Thursday:	09:30 to 23:30
Friday to Saturday:	09:30 to 00:00
Sunday:	12:00 to 23:00
Sundays before Bank Holidays:	12:00 to 00:00

##### Playing of Recorded Music

Unrestricted

##### Late Night Refreshment

Monday to Thursday:	23:00 to 23:30
Friday to Saturday:	23:00 to 00:00
Sundays before Bank Holidays:	23:00 to 00:00

Private Entertainment consisting of dancing, music or other entertainment of a like kind for consideration and with a view to profit Unrestricted

##### Sale by Retail of Alcohol

Monday to Thursday:	10:00 to 23:30
Friday to Saturday:	10:00 to 00:00



Sunday:	12:00 to 22:30
Sundays before Bank Holidays:	12:00 to 00:00

*For times authorised for New Year see conditions at Annex 1 and 3*

**The opening hours of the premises:**

Monday to Thursday:	09:30 to 23:30
Friday to Saturday:	09:30 to 00:00
Sunday:	12:00 to 23:30
Sundays before Bank Holidays:	12:00 to 00:00

**Where the licence authorises supplies of alcohol, whether these are on and/or off supplies:**

Alcohol is supplied for consumption both on and off the Premises.

**Part 2**

**Name, (registered) address, telephone number and email (where relevant) of holder of premises licence:**

Village London Central Limited  
 1 Vincent Square  
 London  
 SW1P 2PN  
*Business Phone Number : 020 7357 6672*

**Registered number of holder, for example company number, charity number (where applicable)**

07208424

**Name, address and telephone number of designated premises supervisor where the premises licence authorises the supply of alcohol:**

**Name:** Mr Alex Winchester

*Please note: It is the policy of the Licensing Authority not to display the address details of a designated premises supervisor.*

**Personal licence number and issuing authority of personal licence held by designated premises supervisor where the premises licence authorises for the supply of alcohol:**

**Licence Number:** 2005/01382/LAPERG  
**Licensing Authority:** London Borough Of Hammersmith & Fulham

**Date:** 30 January 2014

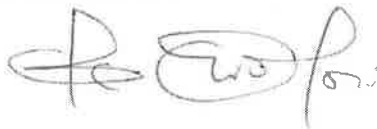

**Signed:** pp

**Operational Director - Premises Management**

## Annex 1 – Mandatory conditions

1. No supply of alcohol may be made at a time when there is no designated premises supervisor in respect of this licence.
2. No supply of alcohol may be made at a time when the designated premises supervisor does not hold a personal licence or the personal licence is suspended.
3. Every supply of alcohol under this licence must be made or authorised by a person who holds a personal licence.
4. (1) The responsible person shall take all reasonable steps to ensure that staff on relevant premises do not carry out, arrange or participate in any irresponsible promotions in relation to the premises.  
  
(2) In this paragraph, an irresponsible promotion means any one or more of the following activities, or substantially similar activities, carried on for the purpose of encouraging the sale or supply of alcohol for consumption on the premises in a manner which carries a significant risk of leading or contributing to crime and disorder, prejudice to public safety, public nuisance, or harm to children;
  - (a) games or other activities which require or encourage, or are designed to require or encourage, individuals to;
    - (i) drink a quantity of alcohol within a time limit (other than to drink alcohol sold or supplied on the premises before the cessation of the period in which the responsible person is authorised to sell or supply alcohol), or
    - (ii) drink as much alcohol as possible (whether within a time limit or otherwise);
  - (b) provision of unlimited or unspecified quantities of alcohol free or for a fixed or discounted fee to the public or to a group defined by a particular characteristic (other than any promotion or discount available to an individual in respect of alcohol for consumption at a table meal, as defined in section 159 of the Act);
  - (c) provision of free or discounted alcohol or any other thing as a prize to encourage or reward the purchase and consumption of alcohol over a period of 24 hours or less;
  - (d) provision of free or discounted alcohol in relation to the viewing on the premises of a sporting event, where that provision is dependent on;
    - (i) the outcome of a race, competition or other event or process, or
    - (ii) the likelihood of anything occurring or not occurring;
  - (e) selling or supplying alcohol in association with promotional posters or flyers on, or in the vicinity of, the premises which can reasonably be considered to condone, encourage or glamorise anti-social behaviour or to refer to the effects of drunkenness in any favourable manner.
5. The responsible person shall ensure that no alcohol is dispensed directly by one person into the mouth of another (other than where that other person is unable to drink without assistance by reason of a disability).
6. The responsible person shall ensure that free tap water is provided on request to customers where it is reasonably available.
7. (1) The premises licence holder or club premises certificate holder shall ensure that an age verification policy applies to the premises in relation to the sale or supply of alcohol.

- (2) The policy must require individuals who appear to the responsible person to be under 18 years of age (or such older age as may be specified in the policy) to produce on request, before being served alcohol, identification bearing their photograph, date of birth and a holographic mark.

8. The responsible person shall ensure that;

- (a) where any of the following alcoholic drinks is sold or supplied for consumption on the premises (other than alcoholic drinks sold or supplied having been made up in advance ready for sale or supply in a securely closed container) it is available to customers in the following measures;

- (i) beer or cider: ½ pint;
- (ii) gin, rum, vodka or whisky: 25 ml or 35 ml; and
- (iii) still wine in a glass: 125 ml; and

- (b) customers are made aware of the availability of these measures.

A responsible person in relation to a licensed premises means the holder of the premise licence in respect of the premises, the designated premises supervisor (if any) or any individual aged 18 or over who is authorised by either the licence holder or designated premises supervisor. For premises with a club premises certificate, any member or officer of the club present on the premises in a capacity that which enables him to prevent the supply of alcohol.

9. Admission of children to the premises must be restricted in accordance with the film classification recommended by the British Board of Film Classification or recommended by this licensing authority as appropriate.

**Conditions reproducing the effect of conditions subject to which relevant existing licences have effect.**

#### **Conditions for Sale of Alcohol**

10. Substantial food and suitable beverages other than intoxicating liquor (including drinking water) shall be available during the whole of the permitted hours in all parts of the premises where intoxicating liquor is sold or supplied.

**Conditions which reproduce the effect of any restriction imposed on the use of the premises by specified enactment**

#### **Conditions related to the Sale of Alcohol**

11. The terminal hour for late night refreshment on New Year's Eve is extended to 05:00 New Year's Day.

## **Annex 2 – Conditions consistent with the operating Schedule**

12. The volume of music being played will be reduced after 23:00.

13. The tables and chairs outside the premises will be removed by 23:00.

### **Annex 3 – Conditions attached after a hearing by the licensing authority**

14. Alcohol shall not be sold, supplied, consumed in or taken from the premises except during permitted hours.

In this condition, permitted hours means:

- (a) On Monday to Thursday 10:00 to 23:30;
- (b) On Friday to Saturday 10:00 to 00:00
- (c) On Sunday 12:00 to 22:30
- (d) On Sunday before Bank Holiday 12:00 to 00:00
- (e) On New Year's Eve from the end of permitted hours on New Year's Eve to the start of permitted hours on the following day (or, if there are no permitted hours on the following day, midnight on 31st December).

NOTE - The above restrictions do not prohibit:

- (a) during the first twenty minutes after the above hours the consumption of the alcohol on the premises;
- (b) during the first twenty minutes after the above hours, the taking of the alcohol from the premises unless the alcohol is supplied or taken in an open vessel;
- (c) during the first thirty minutes after the above hours the consumption of the alcohol on the premises by persons taking table meals there if the alcohol was supplied for consumption as ancillary to the meals;
- (d) the sale or supply of alcohol to or the consumption of alcohol by any person residing in the licensed premises;
- (e) the ordering of alcohol to be consumed off the premises, or the despatch by the vendor of the alcohol so ordered;
- (f) the sale of alcohol to a trader or registered club for the purposes of the trade or club;
- (g) the sale or supply of alcohol to any canteen or mess, being a canteen in which the sale or supply of alcohol is carried out under the authority of the Secretary of State or an authorised mess of members of Her Majesty's naval, military or air forces;
- (h) the taking of alcohol from the premises by a person residing there;
- (i) the supply of alcohol for consumption on the premises to any private friends of a person residing there who are bona fide entertained by him at his own expense, or the consumption of alcohol by persons so supplied;
- (j) the supply of alcohol for consumption on the premises to persons employed there for the purposes of the business carried on by the holder of the licence, or the consumption of liquor so supplied, if the liquor is supplied at the expense of their employer or of the person carrying on or in charge of the business on the premises.

In this condition, any reference to a person residing in the premises shall be construed as including a person not residing there but carrying on or in charge of the business on the premises.

15. No noise shall emanate from the premises nor vibration be transmitted through the structure of the premises which give rise to a nuisance.
16. There shall be no speakers situated or amplification of music or sound within the entrance lobby on the ground floor.

17. The highway and public spaces in the vicinity of the premises shall be kept free of litter from the premises at all materials times to the satisfaction of the Council.
18. All litter and sweepings shall be collected and stored in accordance with the approved refuse storage arrangements.
19. Notices shall be prominently displayed at the ground floors exits requesting the public to respect the needs of local residents and to leave the premises and area quietly.
20. No entertainment, performance, service, or exhibition involving nudity or sexual stimulation which would come within the definition of a sex establishment in Schedule 3 to the Local Government (Miscellaneous Provisions) Act 1982 as amended by the Greater London Council (General Powers) Act 1986 (whether or not locally adopted), shall be provided.
21. There shall be no striptease or nudity, and all persons shall be decently attired at all times.
22. The premises shall install and maintain a comprehensive CCTV system as per the minimum requirements of a Metropolitan Police Crime Prevention Officer. All entry and exit points will be covered enabling frontal identification of every person entering in any light condition. The CCTV system shall continually record whilst the premises is open for licensable activities and during all times when customers remain on the premises. All recordings shall be stored for a minimum period of 31 days with date and time stamping. Recordings shall be made available immediately upon the request of Police or authorised officer throughout the preceding 31 day period.
23. A staff member from the premises who is conversant with the operation of the CCTV system shall be on the premises at all times when the premises is open to the public. This staff member must be able to show a Police or authorised council officer recent data or footage with the absolute minimum of delay when requested.
24. There shall be a personal licence holder on duty at the premises at all times when the premises are open and authorising the sale of alcohol.
25. After 23:00 hours, alcoholic beverages must only be served in the ground floor dining room or in the basement private dining room as ancillary to a substantial bar snack or full table meal or to patrons waiting to dine or having dined.
26. No glasses or bottles shall be allowed to leave the building save for sealed containers after 23:00 hours.

**Annex 4 – Plans**

Attached

LITTLE TITCHFIELD STREET

PROPOSED GROUND FLOOR PLAN

GREAT TITCHFIELD STREET

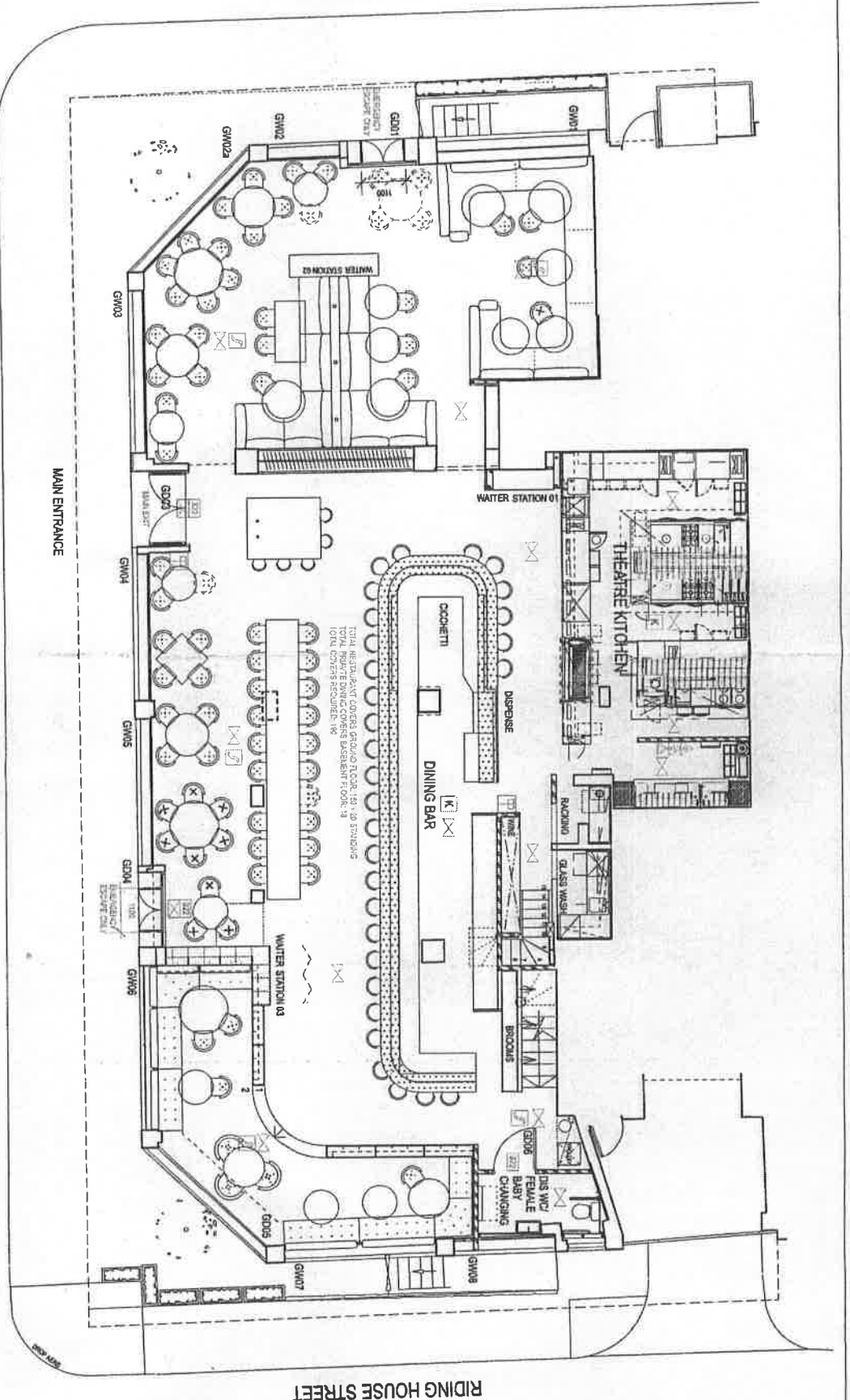

TOTAL RESTAURANT COVERS GROUND FLOOR: 151 + 10 PATIO  
TOTAL PRIVATE DINING COVERS BASEMENT FLOOR: 18  
TOTAL COVERS REQUIRE: 169

All hireable activities take place in the public areas  
Loose furniture is indicative only

KEY TO SYMBOLS	
	EXISTING STRUCTURE
	PROPOSED STRUCTURE
	EXISTING FURNITURE
	PROPOSED FURNITURE
	EXISTING WALL
	PROPOSED WALL
	EXISTING DOOR
	PROPOSED DOOR
	EXISTING WINDOW
	PROPOSED WINDOW
	EXISTING STAIRCASE
	PROPOSED STAIRCASE
	EXISTING LIFT
	PROPOSED LIFT
	EXISTING FLOOR SLAB
	PROPOSED FLOOR SLAB
	EXISTING CEILING
	PROPOSED CEILING
	EXISTING FLOOR FINISH
	PROPOSED FLOOR FINISH
	EXISTING WALL FINISH
	PROPOSED WALL FINISH
	EXISTING CEILING FINISH
	PROPOSED CEILING FINISH
	EXISTING LIGHTING
	PROPOSED LIGHTING
	EXISTING SERVICES
	PROPOSED SERVICES
	EXISTING STRUCTURE TO BE DEMOLISHED
	PROPOSED STRUCTURE TO BE DEMOLISHED

	<b>12 Warbarn Rd, London, NW2 2SR</b> ton@ton-9.co.uk 444 7801 700066
<b>PROJECT</b>	<b>RIDING HOUSE</b>
<b>DRAWING</b>	<b>PROPOSED GROUND FLOOR LICENSING PLAN</b> 1611143-51/102L
<b>SCALE</b>	<b>1:100 AT A3</b>
<b>DATE</b>	<b>JAN 2011</b>
<b>REV C</b>	

DO NOT SCALE FROM DRAWING. ALL DIMS TO BE CHECKED ON SITE.  
REPORT DIMENSIONS AND DIMENSIONS TO THE ARCHITECT IMMEDIATELY







**City of Westminster**  
64 Victoria Street, London, SW1E 6QP

Schedule 12  
Part B

WARD: West End  
UPRN: 100023622103

Premises licence  
summary

Regulation 33, 34

Premises licence number:

13/10224/LIPDPS

**Part 1 – Premises details**

**Postal address of premises:**

The Riding House Café  
43 Great Titchfield Street  
London  
W1W 7PQ

**Telephone Number:** Not Supplied

**Where the licence is time limited, the dates:**

Not applicable

**Licensable activities authorised by the licence:**

Exhibition of a Film  
Playing of Recorded Music  
Late Night Refreshment  
Private Entertainment consisting of dancing, music or other entertainment of a like kind for consideration and with a view to profit  
Sale by Retail of Alcohol

**The times the licence authorises the carrying out of licensable activities:**

**Exhibition of a Film**

Monday to Thursday:	09:30 to 23:30
Friday to Saturday:	09:30 to 00:00
Sunday:	12:00 to 23:00
Sundays before Bank Holidays:	12:00 to 00:00

**Playing of Recorded Music**

**Unrestricted**

**Late Night Refreshment**

Monday to Thursday:	23:00 to 23:30
Friday to Saturday:	23:00 to 00:00
Sundays before Bank Holidays:	23:00 to 00:00

**Private Entertainment consisting of dancing, music or other entertainment of a like kind for consideration and with a view to profit Unrestricted**

**Sale by Retail of Alcohol**

Monday to Thursday:	10:00 to 23:30
---------------------	----------------

Friday to Saturday:	10:00 to 00:00
Sunday:	12:00 to 22:30
Sundays before Bank Holidays:	12:00 to 00:00

*For times authorised for New Year see conditions at Annex 1 and 3*

**The opening hours of the premises:**

Monday to Thursday:	09:30 to 23:30
Friday to Saturday:	09:30 to 00:00
Sunday:	12:00 to 23:30
Sundays before Bank Holidays:	12:00 to 00:00

**Where the licence authorises supplies of alcohol, whether these are on and/or off supplies:**

Alcohol is supplied for consumption both on and off the Premises.

**Name and (registered) address of holder of premises licence:**

Village London Central Limited  
1 Vincent Square  
London  
SW1P 2PN

**Registered number of holder, for example company number, charity number (where applicable)**

07208424

**Name of designated premises supervisor where the premises licence authorises for the supply of alcohol:**

**Name:** Mr Alex Winchester

**State whether access to the premises by children is restricted or prohibited:**

Restricted

**Date:** 30 January 2014



**Signed:** pp

**Operational Director - Premises Management**

# APPENDIX B1

## Comments for Licensing Application 14/06493/LIPV

### Application Summary

Application Number: 14/06493/LIPV

Address: 43 Great Titchfield Street London W1W 7PQ

Proposal: Premises Licence - Variation

Case Officer: Mrs Sumeet Anand-Patel

### Customer Details

Name: Mr Arron Bart

Address: 10 West One House 47 Wells Street London

### Comment Details

Commenter Type: Neighbour

Stance: Customer made comments in support of the Licensing Application

Comment Reasons:

Comment: 10:15 AM on 07 Aug 2014 As a resident in the immediate vicinity of the Riding House Cafe it is very clear to me that the Riding House Cafe is considerably quieter and less disruptive than a number of other local businesses who have much later licences. I therefore fully support their application for extended licensing.

# APPENDIX B2

CITY OF WESTMINSTER

MEMORANDUM

---

TO  
REFERENCE

Ryan Peermamode  
14/07054/LIPV

---

FROM  
BEING DEALT WITH BY  
TELEPHONE  
DATE

EH Consultation Team, 4<sup>th</sup> Floor, City Hall  
Cliona Coleman  
0207 641 6830  
2<sup>nd</sup> September 2014

---

The Licensing Act 2003

Re: 8 Balderton Street London W1K 6TF

I refer to the application for variation of the Premises Licence.

This representation is based on the operating schedule and plans submitted of the fifth floor.

The applicant is seeking the following works

1. To include the fifth floor bedroom terraces within the ambit of the premises license.

I wish to make the following representation

1. An objection is made to the application as the variation will have the likely effect of causing an increase in Public Nuisance in the area.

The applicant has not stated the hours or the proposed activities for the area. The applicant has also not stated who the activities are for, i.e guests or the public

The applicant has not offered any conditions to address the licensing objections of Prevention of Public Nuisance and Public Safety.

Should you wish to discuss the matter further please do not hesitate to contact me.

**Cliona Coleman**  
Environmental Health Officer

## Anand-Patel, Sumeet

---

**From:** Coleman, Cliona  
**Sent:** 02 October 2014 12:06  
**To:** Anand-Patel, Sumeet  
**Subject:** 43 Great Titchfield Street London Conditions.doc  
**Attachments:** 43 Great Titchfield Street London Conditions.doc

Hi Sumeet,

Please see attached conditions for the riding house café.

Please do not forward to applicant.

Thanking you.

**Cliona Coleman**  
Environmental Health Officer  
EH Consultation Team  
Premises Management

T: 020 7641 6830  
E: [ccoleman@westminster.gov.uk](mailto:ccoleman@westminster.gov.uk)

 Please consider your environmental responsibilities before printing this email!

---

TO Licensing Officer

REFERENCE 14/06493/LIPV

---

FROM EH Consultation Team  
BEING DEALT WITH BY Cliona Coleman (ccoleman@westminster.gov.uk)  
TELEPHONE 020 7641 6830  
DATE 2<sup>nd</sup> October 2014

---

**The Licensing Act 2003**

**43 Great Titchfield Street London W1W 7PQ**

Proposed EH conditions:

1. Sales of alcohol for consumption off the premises shall only be supplied with, and ancillary to a take-away meal after 23:00.
2. All tables and chairs outside the premises shall be removed by 23:00.
3. All windows and external doors shall be kept closed after 23:00 hours, or at any time when regulated entertainment takes place, except for the immediate access and egress of persons.
4. Patrons permitted to temporarily leave and then re-enter the premises, e.g. to smoke, shall be limited to 10 persons at any one time.
5. A direct telephone number for the manager at the premises shall be publicly available at all times the premises is open. This telephone number is to be made available to residents and businesses in the vicinity.
6. No waste or recyclable materials, including bottles, shall be moved, removed from or placed in outside areas between 23.00 hours and 08.00 hours on the following day.
7. The number of persons accommodated at any one time (excluding staff) shall not exceed
  - Basement XXX persons
  - Ground Floor XXX persons

Should you wish to discuss the matter further please do not hesitate to contact me.

**Cliona Coleman**  
**Environmental Health Officer**

# APPENDIX B3

## Comments for Licensing Application 14/06493/LIPV

### Application Summary

Application Number: 14/06493/LIPV

Address: 43 Great Titchfield Street London W1W 7PQ

Proposal: Premises Licence - Variation

Case Officer: Mrs Sumeet Anand-Patel

### Customer Details

Name: Mr Francis Salway

Address: Flat 5 47 Wells Street London

### Comment Details

Commenter Type: Neighbour

Stance: Customer objects to the Licensing Application

Comment Reasons:

Comment: 9:32 AM on 18 Aug 2014 I can see no grounds for extending the hours for selling alcohol in a residential district to as late as is proposed in this application. These premises already enjoy a relatively late hour permission for selling alcohol. The sale of alcohol in the area already leads to some evening/late night disturbances for residents.



03/09/2014 14:13:45

# APPENDIX B4

From: "Chris Shaw" <cjs@shawcorporation.com>

Sent: 11/08/2014 15:03:48

To: Premises Licensing

Subject: Ref: 14/06493/LIPV –The Riding House Café, 43 Great Titchfield Street, London W1W 7PQ

Sirs

I wish to formally object to the premises license variation application for the Riding House Café at 43 Great Titchfield Street, London W1W 7PQ.

I do not believe there is any justification for an extension of the existing licence hours and furthermore that proposals to extend the existing licence will set an unhelpful precedent for opening hours to other local licensed premises in a predominantly residential location where the latest opening times on Fridays and Saturdays should not exceed midnight in any licensed establishment.

Regards

Christopher Shaw FRICS

42 Langham Street

London W1W 7AT

T: +44 20 7409 0909

F: +44 20 7499 4499

E: cjs@shaw corporation.com <mailto:cjs@shaw corporation.com>

## Licence &amp; Appeal History

Application	Details of Application	Date Determined	Decision
Conversion and Variation Application  <b>05/04445/LIPCV</b>		21.07.2005	Granted under delegated authority
Vary DPS Application  <b>05/11652/LIPDPS</b>	Application to vary the designated premises supervisor	07.11.2005	Granted Under Delegated Authority
Vary DPS Application  <b>06/03168/LIPDPS</b>	Application to vary the designated premises supervisor	28.04.2006	Granted Under Delegated Authority
Vary DPS Application  <b>07/02211/LIPDPS</b>	Application to vary the designated premises supervisor	27.03.2007	Granted Under Delegated Authority
Vary DPS Application  <b>07/03239/LIPDPS</b>	Application to vary the designated premises supervisor	07.06.2007	Granted Under Delegated Authority
Vary DPS Application  <b>07/07107/LIPDPS</b>	Application to vary the designated premises supervisor	23.08.2007	Granted Under Delegated Authority
Vary DPS Application  <b>07/07738/LIPDPS</b>	Application to vary the designated premises supervisor	24.08.2007	Granted Under Delegated Authority
Vary DPS Application  <b>07/10967/LIPDPS</b>	Application to vary the designated premises supervisor	06.12.2007	Granted Under Delegated Authority
Transfer Application  <b>08/02729/LIPT</b>	Application to transfer the licence to a new Licensee	10.04.2008	Granted Under Delegated Authority
Transfer Application  <b>08/03067/LIPT</b>	Application to transfer the licence to a new Licensee	17.04.2008	Granted Under Delegated Authority
Vary DPS Application  <b>08/05188/LIPDPS</b>	Application to vary the designated premises supervisor	03.08.2007	Granted Under Delegated Authority
Transfer Application  <b>09/03912/LIPT</b>	Application to transfer the licence to a new Licensee	06.08.2009	Granted Under Delegated Authority
Vary DPS Application	Application to vary the designated premises	06.08.2009	Granted Under Delegated Authority

<b>09/03914/LIPDPS</b>	supervisor		
Transfer Application <b>09/05928/LIPT</b>	Application to transfer the licence to a new Licensee	10.11.2009	Granted Under Delegated Authority
Vary DPS Application <b>09/05929/LIPDPS</b>	Application to vary the designated premises supervisor	10.11.2009	Granted Under Delegated Authority
Vary DPS Application <b>09/07220/LIPDPS</b>	Application to vary the designated premises supervisor	10.11.2009	Granted Under Delegated Authority
Transfer Application <b>11/00132/LIPT</b>	Application to transfer the licence to a new Licensee	06.04.2011	Granted Under Delegated Authority
Vary DPS Application <b>11/01070/LIPDPS</b>	Application to vary the designated premises supervisor	11.04.2011	Granted Under Delegated Authority
Minor Variation Application <b>11/01909/LIPVM</b>	Application to vary layout of the premises	30.03.2011	Granted Under Delegated Authority
Variation Application <b>11/03382/LIPV</b>	Application to vary the terminal hour for films, late night refreshment and sale of alcohol	09.06.2011	Granted by Licensing Sub-Committee
Vary DPS Application <b>13/10224/LIPDPS</b>	Application to vary the designated premises supervisor	30.01.2014	Granted Under Delegated Authority
Variation Application <b>14/06493/LIPV</b>	Current Application		Pending

**CONDITIONS CONSISTENT WITH THE OPERATING SCHEDULE AND CONDITIONS PROPOSED BY A PARTY TO THE HEARING**

When determining an application for variation of premises licence under the provisions of the Licensing Act 2003, the licensing authority must, unless it decides to reject the application, grant the licence subject to the conditions which are indicated as mandatory in this schedule.

At a hearing the licensing authority may, in addition, and having regard to any representations received, grant the licence subject to such conditions which are consistent with the operating schedule submitted by the applicant as part of their application, or alter or omit these conditions, or add any new condition to such extent as the licensing authority considers appropriate for the promotion of the licensing objectives.

This schedule lists those conditions which are consistent with the operating schedule, or proposed as appropriate for the promotion of the licensing objectives by a responsible authority or an interested party as indicated. These conditions have not been submitted by the licensing service but reflect the positions of the applicant, responsible authority or interested party and have not necessarily been agreed

**Conditions on Existing Licence****Annex 1 – Mandatory conditions**

1. No supply of alcohol may be made at a time when there is no designated premises supervisor in respect of this licence.
2. No supply of alcohol may be made at a time when the designated premises supervisor does not hold a personal licence or the personal licence is suspended.
3. Every supply of alcohol under this licence must be made or authorised by a person who holds a personal licence.
4. (1) The responsible person shall take all reasonable steps to ensure that staff on relevant premises do not carry out, arrange or participate in any irresponsible promotions in relation to the premises.  
  
(2) In this paragraph, an irresponsible promotion means any one or more of the following activities, or substantially similar activities, carried on for the purpose of encouraging the sale or supply of alcohol for consumption on the premises in a manner which carries a significant risk of leading or contributing to crime and disorder, prejudice to public safety, public nuisance, or harm to children;
  - (a) games or other activities which require or encourage, or are designed to require or encourage, individuals to;
    - (i) drink a quantity of alcohol within a time limit (other than to drink alcohol sold or supplied on the premises before the cessation of the period in which the responsible person is authorised to sell or supply alcohol), or
    - (ii) drink as much alcohol as possible (whether within a time limit or otherwise);
  - (b) provision of unlimited or unspecified quantities of alcohol free or for a fixed or discounted fee to the public or to a group defined by a particular characteristic (other than any promotion or discount available to an individual in respect of alcohol for consumption at a table meal, as defined in section 159 of the Act);
  - (c) provision of free or discounted alcohol or any other thing as a prize to encourage or reward the purchase and consumption of alcohol over a period of 24 hours or less;
  - (d) provision of free or discounted alcohol in relation to the viewing on the premises of a sporting event, where that provision is dependent on;
    - (i) the outcome of a race, competition or other event or process, or
    - (ii) the likelihood of anything occurring or not occurring;

- (e) selling or supplying alcohol in association with promotional posters or flyers on, or in the vicinity of, the premises which can reasonably be considered to condone, encourage or glamorise anti-social behaviour or to refer to the effects of drunkenness in any favourable manner.
5. The responsible person shall ensure that no alcohol is dispensed directly by one person into the mouth of another (other than where that other person is unable to drink without assistance by reason of a disability).
6. The responsible person shall ensure that free tap water is provided on request to customers where it is reasonably available.
7. (1) The premises licence holder or club premises certificate holder shall ensure that an age verification policy applies to the premises in relation to the sale or supply of alcohol.
- (2) The policy must require individuals who appear to the responsible person to be under 18 years of age (or such older age as may be specified in the policy) to produce on request, before being served alcohol, identification bearing their photograph, date of birth and a holographic mark.
8. The responsible person shall ensure that;
- (a) where any of the following alcoholic drinks is sold or supplied for consumption on the premises (other than alcoholic drinks sold or supplied having been made up in advance ready for sale or supply in a securely closed container) it is available to customers in the following measures;
- (i) beer or cider: ½ pint;
- (ii) gin, rum, vodka or whisky: 25 ml or 35 ml; and
- (iii) still wine in a glass: 125 ml; and
- (b) customers are made aware of the availability of these measures.

A responsible person in relation to a licensed premises means the holder of the premise licence in respect of the premises, the designated premises supervisor (if any) or any individual aged 18 or over who is authorised by either the licence holder or designated premises supervisor. For premises with a club premises certificate, any member or officer of the club present on the premises in a capacity that which enables him to prevent the supply of alcohol.

9. Admission of children to the premises must be restricted in accordance with the film classification recommended by the British Board of Film Classification or recommended by this licensing authority as appropriate.

**Conditions reproducing the effect of conditions subject to which relevant existing licences have effect.**

**Conditions for Sale of Alcohol**

10. Substantial food and suitable beverages other than intoxicating liquor (including drinking water) shall be available during the whole of the permitted hours in all parts of the premises where intoxicating liquor is sold or supplied.

**Conditions which reproduce the effect of any restriction imposed on the use of the premises by specified enactment**

**Conditions related to the Sale of Alcohol**

11. The terminal hour for late night refreshment on New Year's Eve is extended to 05:00 New Year's Day.

**Annex 2 – Conditions consistent with the operating Schedule**

12. The volume of music being played will be reduced after 23:00.
13. The tables and chairs outside the premises will be removed by 23:00.

### Annex 3 – Conditions attached after a hearing by the licensing authority

14. Alcohol shall not be sold, supplied, consumed in or taken from the premises except during permitted hours.

In this condition, permitted hours means:

- (a) On Monday to Thursday 10:00 to 23:30;
- (b) On Friday to Saturday 10:00 to 00:00
- (c) On Sunday 12:00 to 22:30
- (d) On Sunday before Bank Holiday 12:00 to 00:00
- (e) On New Year's Eve from the end of permitted hours on New Year's Eve to the start of permitted hours on the following day (or, if there are no permitted hours on the following day, midnight on 31st December).

NOTE - The above restrictions do not prohibit:

- (a) during the first twenty minutes after the above hours the consumption of the alcohol on the premises;
- (b) during the first twenty minutes after the above hours, the taking of the alcohol from the premises unless the alcohol is supplied or taken in an open vessel;
- (c) during the first thirty minutes after the above hours the consumption of the alcohol on the premises by persons taking table meals there if the alcohol was supplied for consumption as ancillary to the meals;
- (d) the sale or supply of alcohol to or the consumption of alcohol by any person residing in the licensed premises;
- (e) the ordering of alcohol to be consumed off the premises, or the despatch by the vendor of the alcohol so ordered;
- (f) the sale of alcohol to a trader or registered club for the purposes of the trade or club;
- (g) the sale or supply of alcohol to any canteen or mess, being a canteen in which the sale or supply of alcohol is carried out under the authority of the Secretary of State or an authorised mess of members of Her Majesty's naval, military or air forces;
- (h) the taking of alcohol from the premises by a person residing there;
- (i) the supply of alcohol for consumption on the premises to any private friends of a person residing there who are bona fide entertained by him at his own expense, or the consumption of alcohol by persons so supplied;
- (j) the supply of alcohol for consumption on the premises to persons employed there for the purposes of the business carried on by the holder of the licence, or the consumption of liquor so supplied, if the liquor is supplied at the expense of their employer or of the person carrying on or in charge of the business on the premises.

In this condition, any reference to a person residing in the premises shall be construed as including a person not residing there but carrying on or in charge of the business on the premises.

15. No noise shall emanate from the premises nor vibration be transmitted through the structure of the premises which give rise to a nuisance.
16. There shall be no speakers situated or amplification of music or sound within the entrance lobby on the ground floor.
17. The highway and public spaces in the vicinity of the premises shall be kept free of litter from the premises at all materials times to the satisfaction of the Council.

18. All litter and sweepings shall be collected and stored in accordance with the approved refuse storage arrangements.
19. Notices shall be prominently displayed at the ground floors exits requesting the public to respect the needs of local residents and to leave the premises and area quietly.
20. No entertainment, performance, service, or exhibition involving nudity or sexual stimulation which would come within the definition of a sex establishment in Schedule 3 to the Local Government (Miscellaneous Provisions) Act 1982 as amended by the Greater London Council (General Powers) Act 1986 (whether or not locally adopted), shall be provided.
21. There shall be no striptease or nudity, and all persons shall be decently attired at all times.
22. The premises shall install and maintain a comprehensive CCTV system as per the minimum requirements of a Metropolitan Police Crime Prevention Officer. All entry and exit points will be covered enabling frontal identification of every person entering in any light condition. The CCTV system shall continually record whilst the premises is open for licensable activities and during all times when customers remain on the premises. All recordings shall be stored for a minimum period of 31 days with date and time stamping. Recordings shall be made available immediately upon the request of Police or authorised officer throughout the preceding 31 day period.
23. A staff member from the premises who is conversant with the operation of the CCTV system shall be on the premises at all times when the premises is open to the public. This staff member must be able to show a Police or authorised council officer recent data or footage with the absolute minimum of delay when requested.
24. There shall be a personal licence holder on duty at the premises at all times when the premises are open and authorising the sale of alcohol.
25. After 23:00 hours, alcoholic beverages must only be served in the ground floor dining room or in the basement private dining room as ancillary to a substantial bar snack or full table meal or to patrons waiting to dine or having dined.
26. No glasses or bottles shall be allowed to leave the building save for sealed containers after 23:00 hours.

#### **Conditions consistent with the operating schedule**

27. No deliveries shall be taken at or dispatched from the site outside the hours of 09:00 and 18:00 Mondays to Saturdays and not at any time on Sundays or Bank or Public Holidays.

#### **Conditions proposed by EH**

28. Sales of alcohol for consumption off the premises shall only be supplied with, and ancillary to a take-away meal after 23:00.
29. All tables and chairs outside the premises shall be removed by 23:00.
30. All windows and external doors shall be kept closed after 23:00 hours, or at any time when regulated entertainment takes place, except for the immediate access and egress of persons.
31. Patrons permitted to temporarily leave and then re-enter the premises, e.g. to smoke, shall be limited to 10 persons at any one time.
32. A direct telephone number for the manager at the premises shall be publicly available at all times the premises is open. This telephone number is to be made available to residents and businesses in the vicinity.
33. No waste or recyclable materials, including bottles, shall be moved, removed from or placed in outside areas between 23.00 hours and 08.00 hours on the following day.
34. The number of persons accommodated at any one time (excluding staff) shall not exceed
  - Basement XXX persons
  - Ground Floor XXX persons

**Following determination of this application, the following mandatory condition shall be added to the licence:**

- A. (i) *A relevant person shall ensure that no alcohol is sold or supplied for consumption on or off the premises for a price which is less than the permitted price.*
- (ii) *For the purposes of the condition set out in paragraph 9(i) above -*
- (a) *"duty" is to be construed in accordance with the Alcoholic Liquor Duties Act 1979;*
- (b) *"permitted price" is the price found by applying the formula -*
- $$P = D + (D \times V)$$
- Where -*
- (i) *P is the permitted price,*
- (ii) *D is the amount of duty chargeable in relation to the alcohol as if the duty were charged on the date of the sale or supply of the alcohol, and*
- (iii) *V is the rate of value added tax chargeable in relation to the alcohol as if the value added tax were charged on the date of the sale or supply of the alcohol;*
- (c) *"relevant person" means, in relation to premises in respect of which there is in force a premises licence -*
- (i) *the holder of the premises licence,*
- (ii) *the designated premises supervisor (if any) in respect of such a licence, or*
- (iii) *the personal licence holder who makes or authorises a supply of alcohol under such a licence;*
- (d) *"relevant person" means, in relation to premises in respect of which there is in force a club premises certificate, any member or officer of the club present on the premises in a capacity which enables the member or officer to prevent the supply in question; and*
- (e) *"value added tax" means value added tax charged in accordance with the Value Added Tax Act 1994.*
- (iii) *Where the permitted price given by Paragraph 9(ii)(b) above would (apart from this paragraph) not be a whole number of pennies, the price given by that sub-paragraph shall be taken to be the price actually given by that sub-paragraph rounded up to the nearest penny.*
- (iv) (1) *Sub-paragraph 9(iv)(2) below applies where the permitted price given by Paragraph 9(ii)(b) above on a day ("the first day") would be different from the permitted price on the next day ("the second day") as a result of a change to the rate of duty or value added tax.*
- (2) *The permitted price which would apply on the first day applies to sales or supplies of alcohol which take place before the expiry of the period of 14 days beginning on the second day.*





# The Riding House Café, 43 Great Titchfield Street, London, W1W 7PQ

City of Westminster

# APPENDIX E

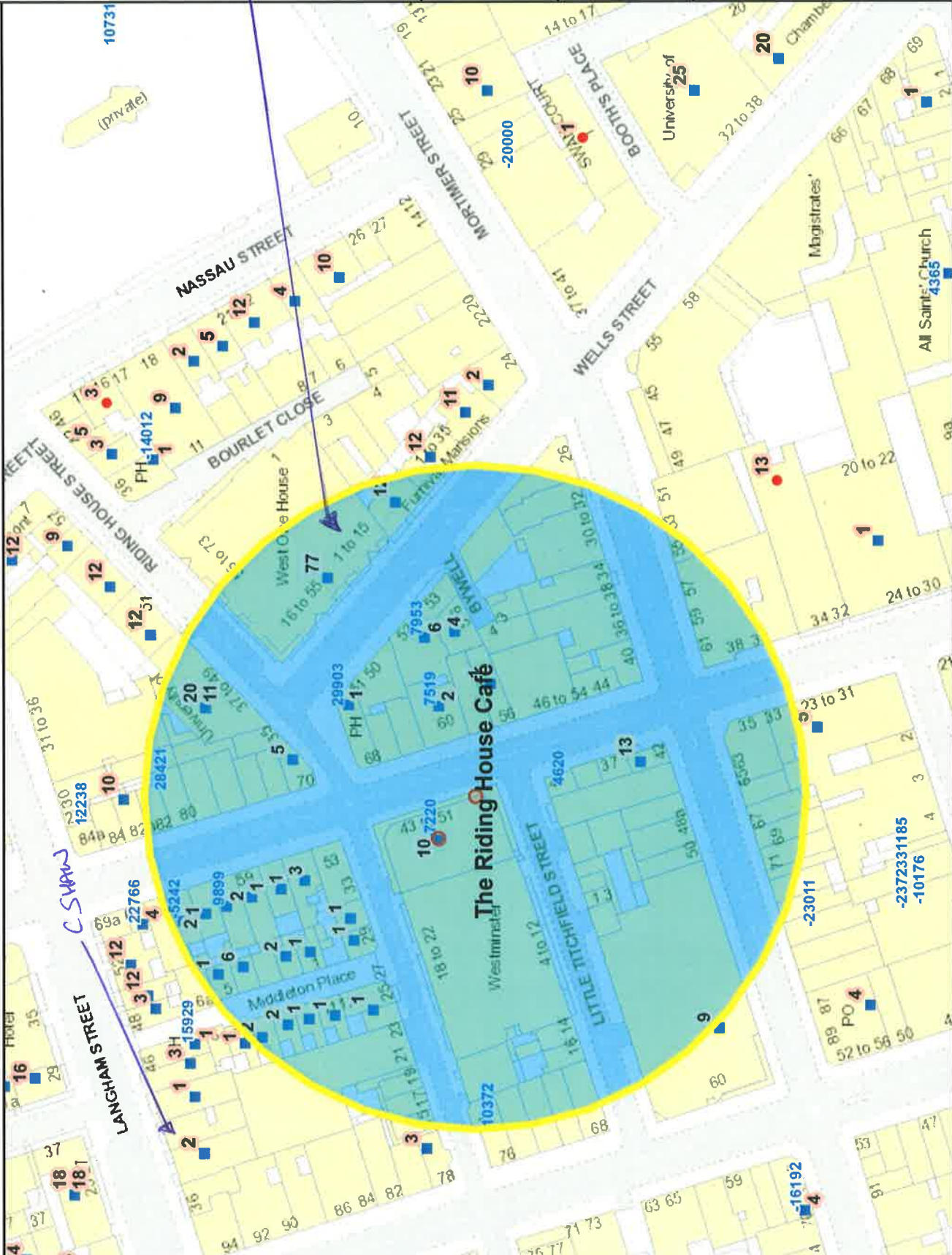

Residential / Proposed Residential	191
Under Construction	0
Other Uses	185
Proportion Residential of all Uses	51%

Data Source: Uniform Database  
Date: 26/09/2014

This product includes mapping data licensed from Ordnance Survey with the permission of the Controller of Her Majesty's Stationery Office. © Crown copyright and/or database right 2013. All rights reserved. Licence number: 1 400010507

10



Meters

**Premises within 75 metres of: The Riding House Café, 43 Great Titchfield Street, London, W1W 7PQ**

<b>p / n</b>	<b>Name of Premises</b>	<b>Premises Address</b>	<b>Licensed Hours</b>
7519	The Sweet Spot	80 Great Titchfield Street London	Monday to Sunday 06:00 - 23:00
7853	Monty's (Wine Bar & Dining)	Basement And Ground Floor 52 Wells Street London W1T 3PR	Monday to Saturday 10:00 - 00:30 Sunday 12:00 - 00:00
-7220	The Riding House Café	43 Great Titchfield Street London W1W 7PQ	Monday to Thursday 09:30 - 23:30 Friday to Saturday 09:30 - 00:00 Sundays before Bank Holidays 12:00 - 00:00 Sunday 12:00 - 23:30
-5242	Shikara Restaurant	Ground Floor 65 Great Titchfield Street London W1W 7PT	Monday to Sunday 12:00 - 15:00 Monday to Sunday 18:00 - 23:30
4820	Harris Delicatessen	41 Great Titchfield Street London W1W 7PF	Monday to Saturday 08:00 - 23:00 Sunday 10:00 - 22:30
28421	Efes One Restaurant	80 - 82 Great Titchfield Street London W1W 7OT	Monday to Saturday 08:00 - 01:30 Sunday 08:00 - 00:30
29903	The King's Arms	88 Great Titchfield Street London W1W 7QL	Monday to Saturday 10:00 - 23:30 Sunday 12:00 - 23:00
9899	Scandinavian Kitchen	Basement And Ground Floor 61 Great Titchfield Street London W1W 7PT	Monday to Sunday 08:00 - 23:00

# APPENDIX F









# John F. Hunt

## CONCRETE CUTTING

[www.johnfhunt.co.uk](http://www.johnfhunt.co.uk)

Diamond Drilling • Diamond Sawing  
Wire Sawing • Robotic Demolition

Telephone 01375 366700

HUNZIK

K21

Kube